

Rubrik 2.39

Außengewinde-Nippel

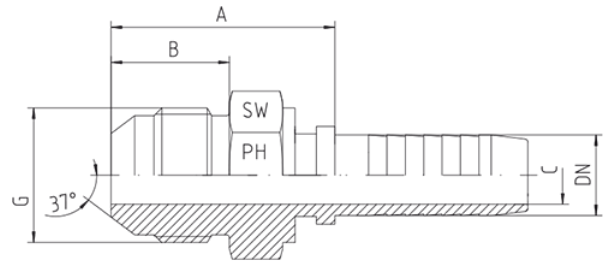
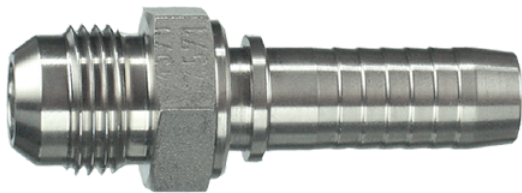

Außengewinde

Schlauch	DN	Gewinde	Ca. Maße				Bestellzeichen
DN	in.	G	A	B	C	SW	
05	3/16"	7/16"-20	21,0	14,0	3,0	12	AGJ-7/16"-DN 05
06	1/4"	7/16"-20	27,5	14,0	4,0	14	AGJ-7/16"-DN 06
05	3/16"	1/2"-20	21,0	14,0	3,0	14	AGJ-1/2"-DN 05
06	1/4"	1/2"-20	27,5	14,0	4,0	17	AGJ-1/2"-DN 06
08	5/16"	1/2"-20	27,5	14,0	5,5	17	AGJ-1/2"-DN 08
05	3/16"	9/16"-18	22,0	14,1	3,0	17	AGJ-9/16"-DN 05
06	1/4"	9/16"-18	29,5	14,1	4,0	17	AGJ-9/16"-DN 06
08	5/16"	9/16"-18	29,5	14,1	5,5	17	AGJ-9/16"-DN 08
10	3/8"	9/16"-18	29,5	14,1	7,0	17	AGJ-9/16"-DN 10
10	3/8"	3/4"-16	33,0	16,7	7,0	22	AGJ-3/4"-DN 10
12	1/2"	3/4"-16	31,0	16,7	9,5	22	AGJ-3/4"-DN 12
10	3/8"	7/8"-14	36,0	19,3	7,0	24	AGJ-7/8"-DN 10
12	1/2"	7/8"-14	36,5	19,3	9,5	24	AGJ-7/8"-DN 12
16	5/8"	7/8"-14	37,0	19,3	12,5	24	AGJ-7/8"-DN 16
12	1/2"	1 1/16"-12	38,5	22,0	9,5	27	AGJ-1 1/16"-DN 12
16	5/8"	1 1/16"-12	40,0	22,0	12,5	27	AGJ-1 1/16"-DN 16
19	3/4"	1 1/16"-12	43,0	22,0	14,5	27	AGJ-1 1/16"-DN 19
19	3/4"	1 5/16"-12	44,0	23,1	14,5	36	AGJ-1 5/16"-DN 19
25	1"	1 5/16"-12	44,0	23,1	20,0	36	AGJ-1 5/16"-DN 25

25	1"	1 5/8"-12	50,0	24,4	20,0	46	AGJ-1 5/8"-DN 25
31	1 1/4"	1 5/8"-12	48,0	24,4	25,5	46	AGJ-1 5/8"-DN 31
31	1 1/4"	1 7/8"-12	51,0	27,5	25,5	50	AGJ-1 7/8"-DN 31
38	1 1/2"	1 7/8"-12	53,5	27,5	31,5	50	AGJ-1 7/8"-DN 38
38	1 1/2"	2 1/2"-12	62,0	33,9	31,5	65	AGJ-2 1/2"-DN 38
51	2"	2 1/2"-12	63,0	33,9	43,0	65	AGJ-2 1/2"-DN 51