

## Rubrik 2.24

### Schwere Reihe - Metrisch - 24°-Konus

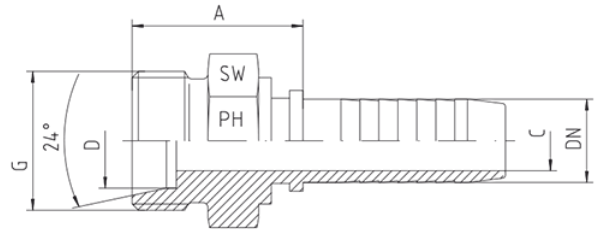
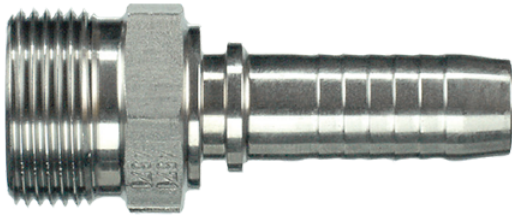

Mit 24°-Konus für Schneidringverschraubungen DIN 2353 / DIN EN ISO 8434-1 Schwere Reihe = CES

Schlauch	DN		Gewinde	Rohr A.D.	Ca. Maße			Bestellzeichen
	DN	in.			A	C	SW	
05		3/16"	M 14 x 1,5	6	23,7	3,0	14	CES-06-DN 05
06		1/4"	M 14 x 1,5	6	25,0	4,0	14	CES-06-DN 06
05		3/16"	M 16 x 1,5	8	23,7	3,0	17	CES-08-DN 05
06		1/4"	M 16 x 1,5	8	25,5	4,0	17	CES-08-DN 06
06		1/4"	M 18 x 1,5	10	25,5	4,0	19	CES-10-DN 06
08		5/16"	M 18 x 1,5	10	25,5	5,5	19	CES-10-DN 08
10		3/8"	M 18 x 1,5	10	25,5	7,0	19	CES-10-DN 10
08		5/16"	M 20 x 1,5	12	27,5	5,5	22	CES-12-DN 08
10		3/8"	M 20 x 1,5	12	25,5	7,0	22	CES-12-DN 10
08		5/16"	M 22 x 1,5	14	27,5	5,5	22	CES-14-DN 08
10		3/8"	M 22 x 1,5	14	28,0	7,0	22	CES-14-DN 10
10		3/8"	M 24 x 1,5	16	28,0	7,0	24	CES-16-DN 10
12		1/2"	M 24 x 1,5	16	28,0	9,5	24	CES-16-DN 12
12		1/2"	M 30 x 2	20	33,0	9,5	30	CES-20-DN 12
16		5/8"	M 30 x 2	20	34,0	12,5	30	CES-20-DN 16
19		3/4"	M 30 x 2	20	37,0	14,5	30	CES-20-DN 19
19		3/4"	M 36 x 2	25	40,0	14,5	36	CES-25-DN 19
25		1"	M 36 x 2	25	40,0	20,0	36	CES-25-DN 25
25		1"	M 42 x 2	30	42,5	20,0	46	CES-30-DN 25
31		1 1/4"	M 52 x 2	38	45,0	25,5	55	CES-38-DN 31