

Rubrik 2.48

Gerade

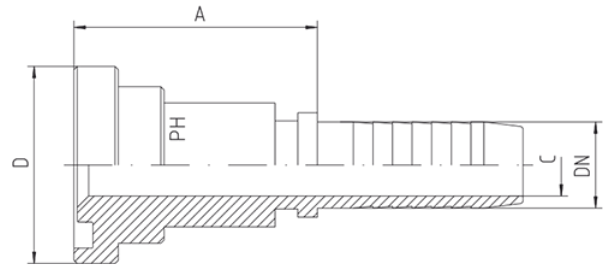

SAE J 518 / ISO 6162 SFL 3 = 3.000 P.S.I. - Gerade SFS 6 = 6.000 P.S.I. - Gerade

Schlauch	DN		Flanschgröße		Ca. Maße		Bestellzeichen
	DN	in.	D	in.	A	C	

Reihe 3.000 P.S.I.

12	1/2"	30,2	1/2"	37,5	9,5	SFL3-1/2"-DN 12
16	5/8"	30,2	1/2"	39,0	12,5	SFL3-1/2"-DN 16
12	1/2"	38,1	3/4"	40,0	9,5	SFL3-3/4"-DN 12
16	5/8"	38,1	3/4"	46,5	12,5	SFL3-3/4"-DN 16
19	3/4"	38,1	3/4"	46,5	14,5	SFL3-3/4"-DN 19
19	3/4"	44,5	1"	46,5	14,5	SFL3-1"-DN 19
25	1"	44,5	1"	38,0	20,0	SFL3-1"-DN 25
25	1"	50,8	1 1/4"	49,0	20,0	SFL3-1 1/4"-DN 25
31	1 1/4"	50,8	1 1/4"	54,0	25,5	SFL3-1 1/4"-DN 31
31	1 1/4"	60,3	1 1/2"	50,0	25,5	SFL3-1 1/2"-DN 31
38	1 1/2"	60,3	1 1/2"	60,0	31,5	SFL3-1 1/2"-DN 38
38	1 1/2"	71,4	2"	62,0	31,5	SFL3-2"-DN 38
51	2"	71,4	2"	48,0	43,0	SFL3-2"-DN 51
60	2 3/8"	84,1	2 1/2"	68,0	51,0	SFL3-2 1/2"-DN 60
63	2 1/2"	84,1	2 1/2"	68,0	55,5	SFL3-2 1/2"-DN 63
51	2"	101,5	3"	64,0	43,0	SFL3-3"-DN 51
76	3"	101,5	3"	87,0	68,5	SFL3-3"-DN 76
80		101,5	3"	71,0	73,0	SFL3-3"-DN 80

Reihe 6.000 P.S.I.

12	1/2"	31,7	1/2"	39,0	9,5	SFS6-1/2"-DN 12
16	5/8"	31,7	1/2"	40,0	12,5	SFS6-1/2"-DN 16
12	1/2"	41,3	3/4"	40,0	9,5	SFS6-3/4"-DN 12
16	5/8"	41,3	3/4"	41,0	12,5	SFS6-3/4"-DN 16
19	3/4"	41,3	3/4"	48,0	14,5	SFS6-3/4"-DN 19
19	3/4"	47,6	1"	65,5	14,5	SFS6-1"-DN 19
25	1"	47,6	1"	68,0	20,0	SFS6-1"-DN 25
25	1"	54,0	1 1/4"	50,5	20,0	SFS6-1 1/4"-DN 25
31	1 1/4"	54,0	1 1/4"	70,0	25,5	SFS6-1 1/4"-DN 31
31	1 1/4"	63,5	1 1/2"	58,0	25,5	SFS6-1 1/2"-DN 31
38	1 1/2"	63,5	1 1/2"	68,0	31,5	SFS6-1 1/2"-DN 38
38	1 1/2"	79,4	2"	76,0	31,5	SFS6-2"-DN 38
51	2"	79,4	2"	86,0	43,0	SFS6-2"-DN 51