

## Rubrik 2.50

### 45°-Bogen

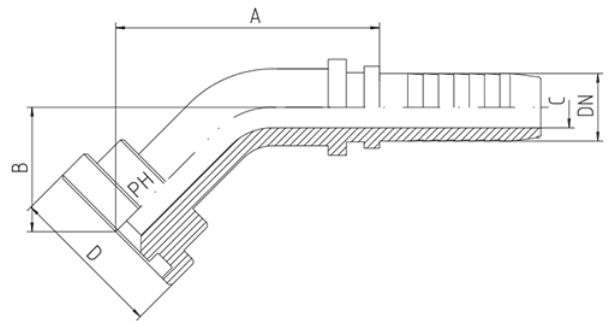

SAE J 518 / ISO 6162 SFL 3 = 3.000 P.S.I. - 45° SFS 6 = 6.000 P.S.I. - 45°

Schlauch	DN	Flanschgröße		Ca. Maße			Bestellzeichen
		DN	in.	A	B	C	

#### Reihe 3.000 P.S.I.

12	1/2"	30,2	1/2"	60,0	30,0	9,5	SFL3-1/2"-45°-DN 12
16	5/8"	30,2	1/2"	90,5	34,0	12,0	SFL3-1/2"-45°-DN 16
12	1/2"	38,1	3/4"	68,5	30,0	9,5	SFL3-3/4"-45°-DN 12
16	5/8"	38,1	3/4"	90,5	34,0	12,0	SFL3-3/4"-45°-DN 16
19	3/4"	38,1	3/4"	85,0	36,0	14,5	SFL3-3/4"-45°-DN 19
19	3/4"	44,5	1"	91,0	31,0	14,5	SFL3-1"-45°-DN 19
25	1"	44,5	1"	90,0	39,0	20,0	SFL3-1"-45°-DN 25
25	1"	50,8	1 1/4"	118,0	43,0	20,0	SFL3-1 1/4"-45°-DN 25
31	1 1/4"	50,8	1 1/4"	111,0	44,0	25,0	SFL3-1 1/4"-45°-DN 31

#### Reihe 3.000

38	1 1/2"	50,8	1 1/4"			31,0	SFL3-1 1/4"-45°-DN 38
----	--------	------	--------	--	--	------	-----------------------

#### Reihe 3.000 P.S.I.

31	1 1/4"	60,3	1 1/2"	138,0	36,0	25,0	SFL3-1 1/2"-45°-DN 31
38	1 1/2"	60,3	1 1/2"	134,0	45,0	31,0	SFL3-1 1/2"-45°-DN 38
38	1 1/2"	71,4	2"	142,0	58,0	31,0	SFL3-2"-45°-DN 38
51	2"	71,4	2"	162,0	57,0	42,0	SFL3-2"-45°-DN 51

60	2 3/8"	84,1	2 1/2"				SFL3-2 1/2"-45°-DN 60
63	2 1/2"	84,1	2 1/2"	223,0	73,5	55,0	SFL3-2 1/2"-45°-DN 63
76	3"	101,5	3"				SFL3-3"-45°-DN 76
80		101,5	3"				SFL3-3"-45°-DN 80

**Reihe 6.000 P.S.I.**

12	1/2"	31,7	1/2"	62,0	32,0	9,5	SFS6-1/2"-45°-DN 12
16	5/8"	31,7	1/2"	71,0	35,0	12,0	SFS6-1/2"-45°-DN 16
12	1/2"	41,3	3/4"	71,0	34,0	9,5	SFS6-3/4"-45°-DN 12
16	5/8"	41,3	3/4"	71,0	32,0	12,0	SFS6-3/4"-45°-DN 16
19	3/4"	41,3	3/4"	85,0	40,0	14,5	SFS6-3/4"-45°-DN 19
19	3/4"	47,6	1"	94,0	31,0	14,5	SFS6-1"-45°-DN 19
25	1"	47,6	1"	92,5	38,5	20,0	SFS6-1"-45°-DN 25
25	1"	54,0	1 1/4"	119,0	47,5	20,0	SFS6-1 1/4"-45°-DN 25
31	1 1/4"	54,0	1 1/4"	112,0	47,0	25,0	SFS6-1 1/4"-45°-DN 31
31	1 1/4"	63,5	1 1/2"	141,5	43,0	25,0	SFS6-1 1/2"-45°-DN 31
38	1 1/2"	63,5	1 1/2"	134,0	48,0	31,0	SFS6-1 1/2"-45°-DN 38
38	1 1/2"	79,4	2"	143,0	64,0	31,0	SFS6-2"-45°-DN 38
51	2"	79,4	2"	165,5	60,0	41,0	SFS6-2"-45°-DN 51