

## Rubrik 6.10

### JIC - Weiblich x JIC - Männlich - Form A

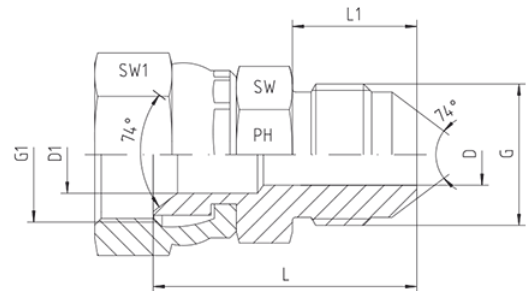
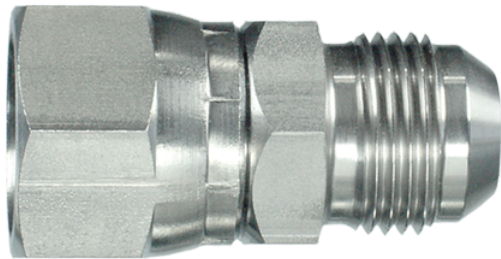

Form A JIC - Männlich JIC - Weiblich - Drehbar

Druck	Rohr A.D.		Gewinde		Ca. Maße						Form	Bestellzeichen
	PN	mm	in.	G1 = UNF/UN	G = UNF/UN	L	L1	D	D1	SW1		
350	6	1/4"	7/16"-20	7/16"-20	29,0	14,0	4,0	4,0	17	12	A	2252511-04-04
350	6	1/4"	1/2"-20	7/16"-20	29,0	14,0	4,0	4,0	17	12	A	2252511-05-04
350	8	5/16"	1/2"-20	1/2"-20	30,0	14,0	5,0	5,0	17	14	A	2252511-05-05
350	8	5/16"	9/16"-18	1/2"-20	30,7	14,0	5,0	5,0	19	14	A	2252511-06-05
350	10	3/8"	9/16"-18	9/16"-18	30,7	14,0	6,5	6,5	19	17	A	2252511-06-06
350	12	1/2"	9/16"-18	3/4"-16	34,5	17,0	9,5	7,0	19	22	A	2252511-06-08
350	12	1/2"	3/4"-16	3/4"-16	35,5	17,0	9,5	9,5	24	22	A	2252511-08-08
350	14, 15, 16	5/8"	3/4"-16	7/8"-14	39,4	19,5	12,0	10,0	24	24	A	2252511-08-10
280	25	1"	3/4"-16	1 5/16"-12	44,0	23,0	21,0	9,5	24	36	A	2252511-08-16
350	12	1/2"	7/8"-14	3/4"-16	36,5	17,0	9,5	11,0	27	22	A	2252511-10-08
350	14, 15, 16	5/8"	7/8"-14	7/8"-14	40,5	19,5	12,0	12,0	27	24	A	2252511-10-10
350	18, 20	3/4"	7/8"-14	1 1/16"-12	45,5	22,0	15,0	12,0	27	27	A	2252511-10-12
350	14, 15, 16	5/8"	1 1/16"-12	7/8"-14	40,6	19,5	12,0	15,0	32	27	A	2252511-12-10
350	18, 20	3/4"	1 1/16"-12	1 1/16"-12	45,6	22,0	15,0	15,0	32	32	A	2252511-12-12
280	25	1"	1 5/16"-12	1 5/16"-12	48,7	23,0	21,0	21,0	41	36	A	2252511-16-16
210	28, 30, 32	1 1/2"	1 5/16"-12	1 5/8"-12	53,0	24,3	26,5	19,0	50	46	A	2252511-16-20
210	28, 30, 32	1 1/4"	1 5/8"-12	1 5/8"-12	56,0	24,3	27,5	27,5	50	46	A	2252511-20-20
210	35, 38	1 1/2"	1 7/8"-12	1 7/8"-12	60,0	27,5	33,0	33,0	55	50	A	2252511-24-24
150	35, 38	1 1/2"	2 1/2"-12	1 7/8"-12	66,5	27,5	32,0	44,0	70	65	A	2252511-32-24