

## Rubrik 6.35

### Muttern

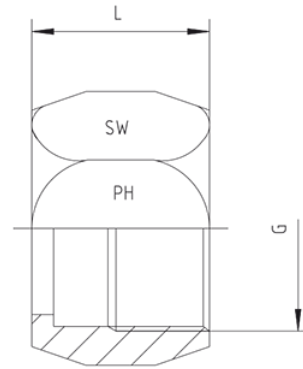

Für 37°-Bördelverschraubungen Nach SAE J 514 und ISO 8434 Teil 2

Rohr A.D.		Gewinde	Ca. Maße		Bestellzeichen
mm	in.		L	SW	
6	1/4"	7/16"-20 UNF	15,5	14	M-37-06-04
8	5/16"	1/2"-20 UNF	17,0	17	M-37-08-05
10	3/8"	9/16"-18 UNF	18,3	19	M-37-10-06
12	1/2"	3/4"-16 UNF	21,3	22	M-37-12-08
14, 15, 16	5/8"	7/8"-14 UNF	24,6	27	M-37-16-10
18, 20	3/4"	1 1/16"-12 UN	25,9	32	M-37-20-12
25	1"	1 5/16"-12 UN	28,4	41	M-37-25-16
28, 30, 32	1 1/4"	1 5/8"-12 UN	31,0	50	M-37-30-20
35,38	1 1/2"	1 7/8"-12 UN	35,8	60	M-37-38-24
50	2"	2 1/2"-12 UN	44,2	75	M-37-50-32