

## Rubrik 8.130

### Metrisch - Zylindrisch - SC

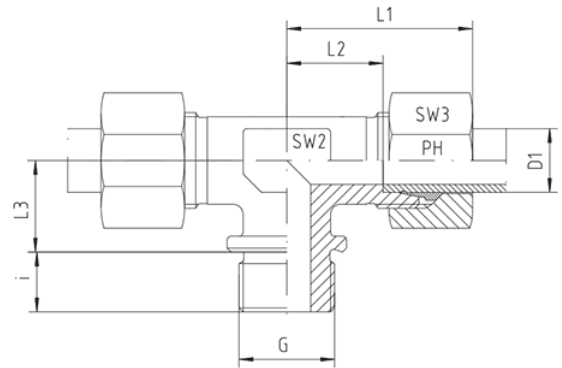

T-Einschraubverschraubungen L- und S-Reihe Einschraubgewinde: Metrisches Feingewinde - Zylindrisch  
 Abdichtung durch Dichtkante Form B

| Druck          | Rohr A.D. | Gewinde        | Ca. Maße |      |    |    |     |     | Bestellzeichen        |  |
|----------------|-----------|----------------|----------|------|----|----|-----|-----|-----------------------|--|
|                |           |                | L1       | L2   | L3 | i  | SW2 | SW3 |                       |  |
| PN             | D1        | G              |          |      |    |    |     |     |                       |  |
| <b>Reihe L</b> |           |                |          |      |    |    |     |     |                       |  |
| 160            | 22        | M 26 x 1,5 zyl | 44       | 27,5 | 26 | 16 | 27  | 36  | TE-L-22-M 26x1,5-z-SC |  |
| 160            | 28        | M 33 x 2 zyl   | 47       | 30,5 | 30 | 18 | 36  | 41  | TE-L-28-M 33x2-z-SC   |  |
| 160            | 35        | M 42 x 2 zyl   | 56       | 34,5 | 34 | 20 | 41  | 50  | TE-L-35-M 42x2-z-SC   |  |
| 160            | 42        | M 48 x 2 zyl   | 63       | 40,0 | 39 | 22 | 50  | 60  | TE-L-42-M 48x2-z-SC   |  |
| <b>Reihe S</b> |           |                |          |      |    |    |     |     |                       |  |
| 400            | 20        | M 27 x 2 zyl   | 48       | 26,5 | 26 | 16 | 27  | 36  | TE-S-20-M 27x2-z-SC   |  |
| 250            | 25        | M 33 x 2 zyl   | 54       | 30,0 | 30 | 18 | 36  | 46  | TE-S-25-M 33x2-z-SC   |  |
| 160            | 30        | M 42 x 2 zyl   | 62       | 35,5 | 34 | 20 | 41  | 50  | TE-S-30-M 42x2-z-SC   |  |
| 160            | 38        | M 48 x 2 zyl   | 72       | 41,0 | 39 | 22 | 50  | 60  | TE-S-38-M 48x2-z-SC   |  |