

Rubrik 8.262

Konus-Reduzieranschlüsse - SC

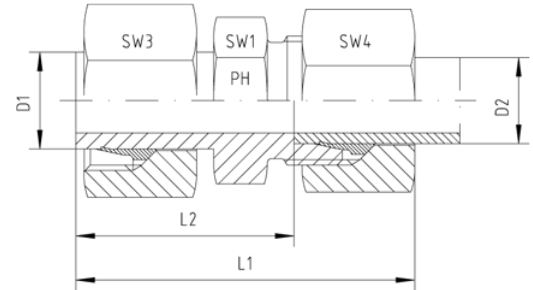
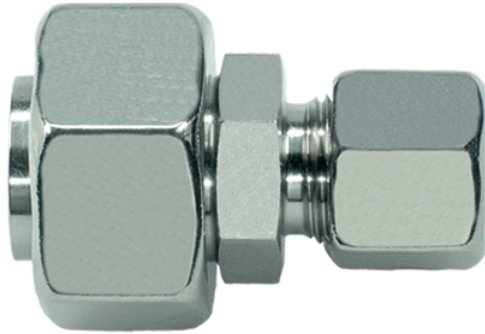

Anschluss D1 ist vormontiert. Die Fertigmontage erfolgt im Stutzen mit ca. 1/2 Umdrehung der Überwurfmutter über den Punkt des deutlich spürbaren Kraftanstieges.

Druck	Rohr A.D.		Ca. Maße					Bestellzeichen
PN	D1	D2	L1	L2	SW1	SW3	SW4	
Reihe L								
315	8	6	43,5	25,5	12	17	14	KOR-L-08/06-SC
315	10	6	44,0	29,0	12	19	14	KOR-L-10/06-SC
315	10	8	44,0	29,0	14	19	17	KOR-L-10/08-SC
315	12	6	44,0	29,0	14	22	14	KOR-L-12/06-SC
315	12	8	44,0	29,0	14	22	17	KOR-L-12/08-SC
315	12	10	45,0	30,0	17	22	19	KOR-L-12/10-SC
315	15	6	45,5	30,5	17	27	14	KOR-L-15/06-SC
315	15	8	45,5	30,5	17	27	17	KOR-L-15/08-SC
315	15	10	46,5	31,5	17	27	19	KOR-L-15/10-SC
315	15	12	46,5	31,5	19	27	22	KOR-L-15/12-SC
315	18	6	47,5	32,5	19	32	14	KOR-L-18/06-SC
315	18	8	47,5	32,5	19	32	17	KOR-L-18/08-SC
315	18	10	48,0	33,0	19	32	19	KOR-L-18/10-SC
315	18	12	48,0	33,0	19	32	22	KOR-L-18/12-SC
315	18	15	49,0	34,0	24	32	27	KOR-L-18/15-SC
160	22	6	50,0	35,0	24	36	14	KOR-L-22/06-SC
160	22	8	50,0	35,0	24	36	17	KOR-L-22/08-SC
160	22	10	51,0	36,0	24	36	19	KOR-L-22/10-SC

160	22	12	51,0	36,0	24	36	22	KOR-L-22/12-SC
160	22	15	52,0	37,0	24	36	27	KOR-L-22/15-SC
160	22	18	53,0	36,5	27	36	32	KOR-L-22/18-SC
160	28	6	50,0	35,0	30	41	14	KOR-L-28/06-SC
160	28	8	50,0	35,0	30	41	17	KOR-L-28/08-SC
160	28	10	51,0	36,0	30	41	19	KOR-L-28/10-SC
160	28	12	51,0	36,0	30	41	22	KOR-L-28/12-SC
160	28	15	52,0	37,0	30	41	27	KOR-L-28/15-SC
160	28	18	54,0	37,5	30	41	32	KOR-L-28/18-SC
160	28	22	55,5	39,0	30	41	36	KOR-L-28/22-SC
160	35	6	58,0	43,0	36	50	14	KOR-L-35/06-SC
160	35	8	58,0	43,0	36	50	17	KOR-L-35/08-SC
160	35	10	59,0	44,0	36	50	19	KOR-L-35/10-SC
160	35	12	59,0	44,0	36	50	22	KOR-L-35/12-SC
160	35	15	60,0	45,0	36	50	27	KOR-L-35/15-SC
160	35	18	61,0	44,5	36	50	32	KOR-L-35/18-SC
160	35	22	63,0	46,5	36	50	36	KOR-L-35/22-SC
160	35	28	63,0	46,5	41	50	41	KOR-L-35/28-SC
160	42	6	59,0	44,0	36	60	14	KOR-L-42/06-SC
160	42	8	59,0	44,0	46	60	17	KOR-L-42/08-SC
160	42	10	60,0	45,0	46	60	19	KOR-L-42/10-SC
160	42	12	60,0	45,0	46	60	22	KOR-L-42/12-SC
160	42	15	61,0	46,0	46	60	27	KOR-L-42/15-SC
160	42	18	59,0	44,0	46	60	32	KOR-L-42/18-SC
160	42	22	63,0	46,5	46	60	36	KOR-L-42/22-SC
160	42	28	64,0	47,5	46	60	41	KOR-L-42/28-SC
160	42	35	69,0	47,5	46	60	50	KOR-L-42/35-SC