

## Rubrik 8.94

### UNF -SC

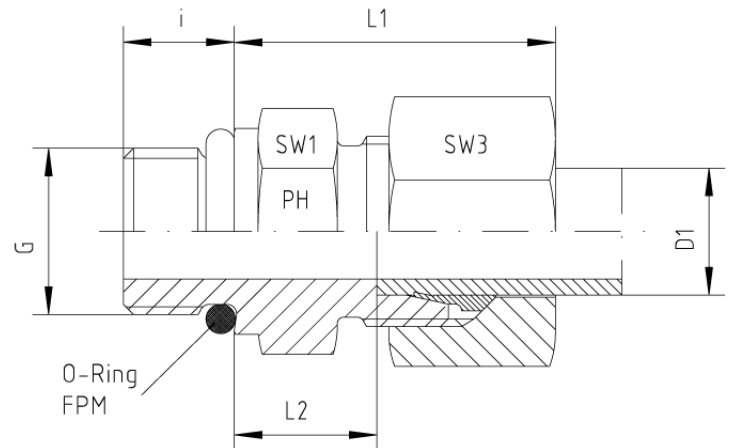
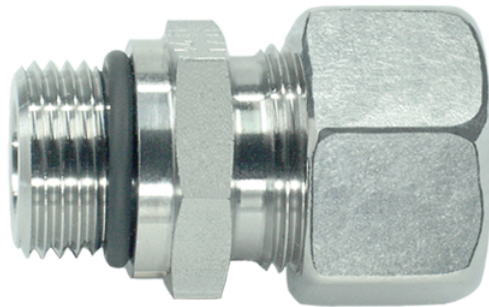

Gerade Einschraubverschraubungen L-Reihe Einschraubgewinde: UNF (ASA B 1.1 - 1960) Abdichtung durch FKM Runddichtring (O-Ring) - SAE J 514 Achtung: Spezielle Gewindeausenkung erforderlich. Andere Sprunggrößen auf Anfrage!

Druck	Rohr A.D.	Gewinde	Ca. Maße					O-Ring	Bestellzeichen	Brutto-
PN	D1	G	L1	L2	i	SW1	SW3			Preis (€)

#### Reihe L

315	6	7/16"-20 UNF	23,5	9,0	9,2	17	14	8,92 x 1,83	GE-L-06-7/16"-UNF-SC	23,03
315	6	1/2"-20 UNF	28,0	10,0	9,2	17	14	10,52 x 1,83	GE-L-06-1/2"-UNF-SC	23,03
315	6	9/16"-18 UNF	27,5	10,0	10,0	19	14	11,90 x 1,98	GE-L-06-9/16"-UNF-SC	23,03
315	8	7/16"-20 UNF	25,0	10,0	9,2	17	17	8,92 x 1,83	GE-L-08-7/16"-UNF-SC	23,64
315	8	1/2"-20 UNF	25,0	10,0	9,2	17	17	10,52 x 1,83	GE-L-08-1/2"-UNF-SC	23,64
315	8	9/16"-18 UNF	25,0	10,0	10,0	19	17	11,90 x 1,98	GE-L-08-9/16"-UNF-SC	23,64
315	10	7/16"-20 UNF	26,0	11,0	9,2	17	19	8,92 x 1,83	GE-L-10-7/16"-UNF-SC	24,20
315	10	1/2"-20 UNF	26,0	11,0	9,2	17	19	10,52 x 1,83	GE-L-10-1/2"-UNF-SC	24,20
315	10	9/16"-18 UNF	26,0	11,0	10,0	19	19	11,90 x 1,98	GE-L-10-9/16"-UNF-SC	24,20
315	10	3/4"-16 UNF	30,5	13,0	11,2	24	19	16,36 x 2,20	GE-L-10-3/4"-UNF-SC	25,85
315	12	9/16"-18 UNF	26,0	12,5	10,0	19	22	11,90 x 1,98	GE-L-12-9/16"-UNF-SC	24,20
315	12	3/4"-16 UNF	27,0	12,5	11,2	24	22	16,36 x 2,20	GE-L-12-3/4"-UNF-SC	26,50
315	12	7/8"-14 UNF	27,5	13,5	12,7	27	22	19,18 x 2,46	GE-L-12-7/8"-UNF-SC	27,20
315	15	9/16"-18 UNF	29,0	14,0	10,0	24	27	11,90 x 1,98	GE-L-15-9/16"-UNF-SC	30,07

315	15	3/4"-16 UNF	29,0	14,0	11,2	24	27	16,36 x 2,20	GE-L-15-3/4"-UNF-SC	28,27
315	15	7/8"-14 UNF	29,0	14,0	12,7	27	27	19,18 x 2,46	GE-L-15-7/8"-UNF-SC	28,97
315	18	3/4"-16 UNF	31,0	14,5	11,2	27	32	16,36 x 2,20	GE-L-18-3/4"-UNF-SC	34,11
315	18	7/8"-14 UNF	31,0	14,5	12,7	27	32	19,18 x 2,46	GE-L-18-7/8"-UNF-SC	34,11
315	18	1 1/16"-12 UN	31,0	14,5	15,0	32	32	23,47 x 2,95	GE-L-18-1 1/16"-UN-SC	47,06
160	22	3/4"-16 UNF	33,0	16,5	11,2	32	36	16,36 x 2,20	GE-L-22-3/4"-UNF-SC	49,77
160	22	7/8"-14 UNF	33,0	16,5	12,7	32	36	19,18 x 2,46	GE-L-22-7/8"-UNF-SC	49,77
160	22	1 1/16"-12 UN	33,0	16,5	15,0	32	36	23,47 x 2,95	GE-L-22-1 1/16"-UN-SC	48,17
160	22	1 5/16"-12 UN	33,0	16,5	15,0	41	36	29,74 x 2,95	GE-L-22-1 5/16"-UN-SC	66,92
160	28	7/8"-14 UNF	34,0	17,5	12,7	41	41	19,18 x 2,46	GE-L-28-7/8"-UNF-SC	82,61
160	28	1 1/16"-12 UN	34,0	17,5	15,0	41	41	23,47 x 2,95	GE-L-28-1 1/16"-UN-SC	71,65
160	28	1 5/16"-12 UN	34,0	17,5	15,0	41	41	29,74 x 2,95	GE-L-28-1 5/16"-UN-SC	70,80
160	28	1 5/8"-12 UN	34,0	17,5	15,0	50	41	37,46 x 3,00	GE-L-28-1 5/8"-UN-SC	198,50
160	35	1 1/16"-12 UN	39,0	17,0	15,0	46	50	23,47 x 2,95	GE-L-35-1 1/16"-UN-SC	170,38
160	35	1 5/16"-12 UN	39,0	17,5	15,0	46	50	29,74 x 2,95	GE-L-35-1 5/16"-UN-SC	158,77
160	35	1 5/8"-12 UN	39,0	17,5	15,0	50	50	37,46 x 3,00	GE-L-35-1 5/8"-UN-SC	153,43
160	42	1 5/8"-12 UN	42,0	19,0	15,0	55	60	37,46 x 3,00	GE-L-42-1 5/8"-UN-SC	206,69
160	42	1 7/8"-12 UN	42,0	19,0	15,0	55	60	43,69 x 3,00	GE-L-42-1 7/8"-UN-SC	206,69