

Rubrik 9.15

EW-Verschraubungen - Whitworth - Zyl. - SC

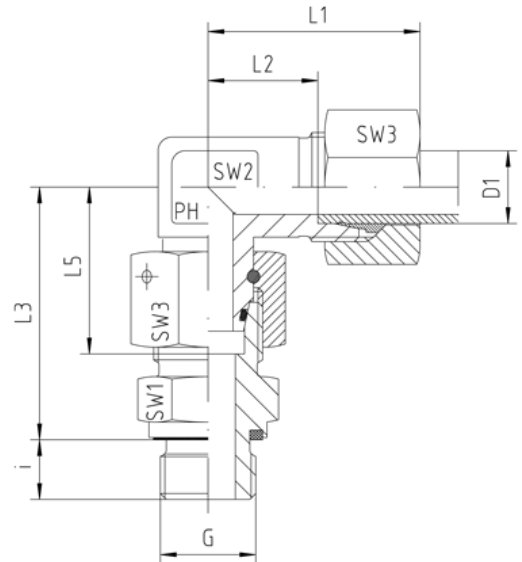
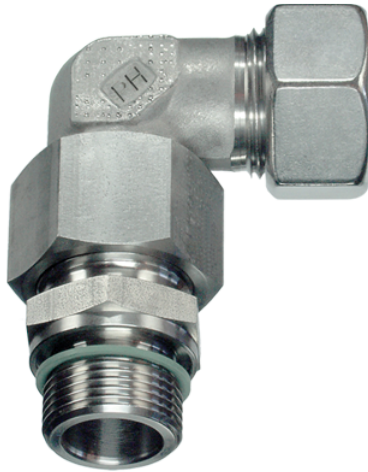

Einstellbare Winkel-Verschraubungen mit Dichtkegel und O-Ring FKM Rohrseitig Schneidringanschluss Einschraubgewinde: Whitworth-Rohrgewinde - Zylindrisch wd = Abdichtung durch Profildichtung - FKM

Druck	Rohr A.D.	Gewinde	Ca. Maße								Bestellzeichen
			L1	L2	L3	L5	i	SW1	SW2	SW3	
PN	D1	G									

Reihe L

500	6	G 1/8"	27	12,0	34,5	26,0	8	14	12	14	EW-DKOL-06-G 1/8"-wd-SC
500	8	G 1/4"	29	14,0	37,5	27,5	12	17	12	17	EW-DKOL-08-G 1/4"-wd-SC
500	10	G 1/4"	30	15,0	40,0	29,0	12	19	14	19	EW-DKOL-10-G 1/4"-wd-SC
400	12	G 1/4"	32	17,0	42,0	29,5	12	19	17	22	EW-DKOL-12-G 1/4"-wd-SC
400	12	G 3/8"	32	17,0	42,0	29,5	12	22	17	22	EW-DKOL-12-G 3/8"-wd-SC
400	12	G 1/2"	32	17,0	43,0	29,5	14	27	17	22	EW-DKOL-12-G 1/2"-wd-SC
400	15	G 1/2"	36	21,0	46,0	32,5	14	27	19	27	EW-DKOL-15-G 1/2"-wd-SC
400	18	G 1/2"	40	23,5	50,0	35,5	14	27	24	32	EW-DKOL-18-G 1/2"-wd-SC
250	22	G 3/4"	44	27,5	55,0	38,5	16	32	27	36	EW-DKOL-22-G 3/4"-wd-SC
250	28	G 1"	47	30,5	59,0	41,5	18	41	36	41	EW-DKOL-28-G 1"-wd-SC
250	35	G 1 1/4"	56	34,5	68,5	51,0	20	50	41	50	EW-DKOL-35-G 1 1/4"-wd-SC
250	42	G 1 1/2"	63	40,0	75,0	56,0	22	55	50	60	EW-DKOL-42-G 1 1/2"-wd-SC

Reihe S

800	6	G 1/4"	31	16,0	40,0	27,0	12	19	12	17	EW-DKOS-06-G 1/4"-wd-SC
800	8	G 1/4"	32	17,0	42,5	27,5	12	19	14	19	EW-DKOS-08-G 1/4"-wd-SC
800	10	G 3/8"	34	17,5	45,0	30,0	12	22	17	22	EW-DKOS-10-G 3/8"-wd-SC
630	12	G 3/8"	38	21,5	48,0	31,0	12	22	17	24	EW-DKOS-12-G 3/8"-wd-SC

630	12	G 1/2"	38	21,5	49,0	31,0	14	27	17	24	EW-DKOS-12-G 1/2"-wd-SC
630	14	G 1/2"	40	22,0	54,0	35,0	14	27	19	27	EW-DKOS-14-G 1/2"-wd-SC
630	16	G 1/2"	43	24,5	55,0	36,5	14	27	24	30	EW-DKOS-16-G 1/2"-wd-SC
420	20	G 3/4"	48	26,5	65,0	44,5	16	32	27	36	EW-DKOS-20-G 3/4"-wd-SC
420	25	G 1"	54	30,0	73,0	50,0	18	41	36	46	EW-DKOS-25-G 1"-wd-SC
420	30	G 1 1/4"	62	35,5	78,5	55,0	20	50	41	50	EW-DKOS-30-G 1 1/4"-wd-SC
420	38	G 1 1/2"	72	41,0	89,0	63,0	22	55	50	60	EW-DKOS-38-G 1 1/2"-wd-SC