

## Rubrik 9.43

### Reduzier-Verschraubungen RED - DKOL - OMD

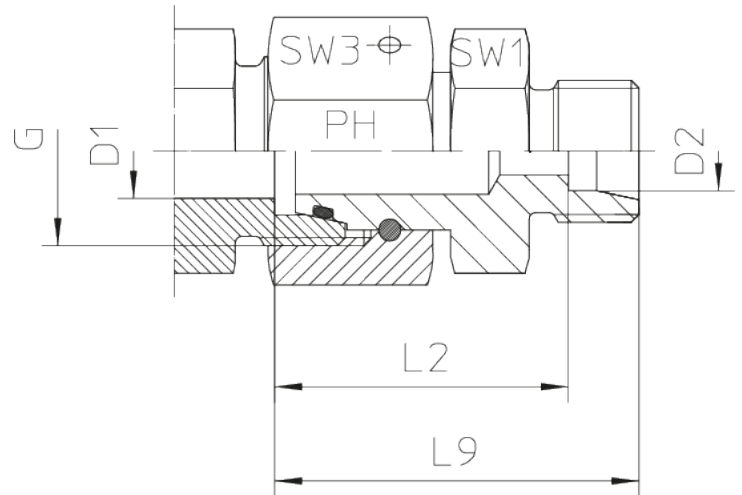
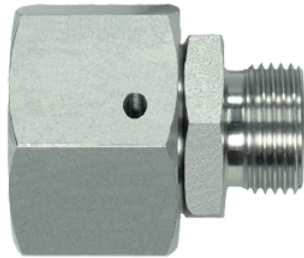

Mit Dichtkegel und O-Ring (DKO) - FKM Passend in Bohrungsform W DIN 3861 Andere Abmessungen auf Anfrage!

Druck	Rohr A.D.		Gewinde	Ca. Maße				Bestellzeichen
	D1	D2		G	L2	L9	SW1	

#### Reihe L

500	8	6	M 14 x 1,5	23,5	30,5	12	17	RED-DKOL-08/06-OMD
500	10	6	M 16 x 1,5	25,0	38,0	14	19	RED-DKOL-10/06-OMD
500	10	8	M 16 x 1,5	25,0	32,0	14	19	RED-DKOL-10/08-OMD
400	12	6	M 18 x 1,5	25,0	32,0	17	22	RED-DKOL-12/06-OMD
400	12	8	M 18 x 1,5	25,0	32,0	17	22	RED-DKOL-12/08-OMD
400	12	10	M 18 x 1,5	26,0	33,0	17	22	RED-DKOL-12/10-OMD
400	15	6	M 22 x 1,5	28,5	35,5	19	27	RED-DKOL-15/06-OMD
400	15	8	M 22 x 1,5	28,0	35,5	19	27	RED-DKOL-15/08-OMD
400	15	10	M 22 x 1,5	29,5	36,5	19	27	RED-DKOL-15/10-OMD
400	15	12	M 22 x 1,5	29,5	36,5	19	27	RED-DKOL-15/12-OMD
400	18	6	M 26 x 1,5	28,0	35,0	24	32	RED-DKOL-18/06-OMD
400	18	8	M 26 x 1,5	28,0	35,0	24	32	RED-DKOL-18/08-OMD
400	18	10	M 26 x 1,5	29,0	35,0	24	32	RED-DKOL-18/10-OMD
400	18	12	M 26 x 1,5	29,0	35,0	24	32	RED-DKOL-18/12-OMD
400	18	15	M 26 x 1,5	30,0	37,0	24	32	RED-DKOL-18/15-OMD
250	22	6	M 30 x 2	32,0	39,0	27	36	RED-DKOL-22/06-OMD
250	22	8	M 30 x 2	32,0	39,0	27	36	RED-DKOL-22/08-OMD
250	22	10	M 30 x 2	33,0	40,0	27	36	RED-DKOL-22/10-OMD

250	22	12	M 30 x 2	33,0	40,0	27	36	RED-DKOL-22/12-OMD
250	22	15	M 30 x 2	34,0	41,0	27	36	RED-DKOL-22/15-OMD
250	22	18	M 30 x 2	33,5	41,0	27	36	RED-DKOL-22/18-OMD
250	28	6	M 36 x 2	34,0	41,0	32	41	RED-DKOL-28/06-OMD
250	28	8	M 36 x 2	34,0	41,0	32	41	RED-DKOL-28/08-OMD
250	28	10	M 36 x 2	35,0	42,0	32	41	RED-DKOL-28/10-OMD
250	28	12	M 36 x 2	35,0	42,0	32	41	RED-DKOL-28/12-OMD
250	28	15	M 36 x 2	36,0	43,0	32	41	RED-DKOL-28/15-OMD
250	28	18	M 36 x 2	35,5	43,0	32	41	RED-DKOL-28/18-OMD
250	28	22	M 36 x 2	37,5	45,0	32	41	RED-DKOL-28/22-OMD
250	35	6	M 45 x 2	37,0	44,0	41	50	RED-DKOL-35/06-OMD
250	35	8	M 45 x 2	37,0	44,0	41	50	RED-DKOL-35/08-OMD
250	35	10	M 45 x 2	38,0	45,0	41	50	RED-DKOL-35/10-OMD
250	35	12	M 45 x 2	38,0	45,0	41	50	RED-DKOL-35/12-OMD
250	35	15	M 45 x 2	39,0	46,0	41	50	RED-DKOL-35/15-OMD
250	35	18	M 45 x 2	38,5	46,0	41	50	RED-DKOL-35/18-OMD
250	35	22	M 45 x 2	40,5	48,0	41	50	RED-DKOL-35/22-OMD
250	35	28	M 45 x 2	40,5	48,0	41	50	RED-DKOL-35/28-OMD
250	42	6	M 52 x 2	40,5	47,5	50	60	RED-DKOL-42/06-OMD
250	42	8	M 52 x 2	40,5	47,5	50	60	RED-DKOL-42/08-OMD
250	42	10	M 52 x 2	41,5	48,5	50	60	RED-DKOL-42/10-OMD
250	42	12	M 52 x 2	41,5	48,5	50	60	RED-DKOL-42/12-OMD
250	42	15	M 52 x 2	42,5	49,5	50	60	RED-DKOL-42/15-OMD
250	42	18	M 52 x 2	42,0	49,5	50	60	RED-DKOL-42/18-OMD
250	42	22	M 52 x 2	44,0	51,5	50	60	RED-DKOL-42/22-OMD
250	42	28	M 52 x 2	44,0	51,5	50	60	RED-DKOL-42/28-OMD
250	42	35	M 52 x 2	43,0	53,5	50	60	RED-DKOL-42/35-OMD