

Rubrik 9.17

EW-Verschraubungen - Metr. Feingewinde - Zyl. - Standard

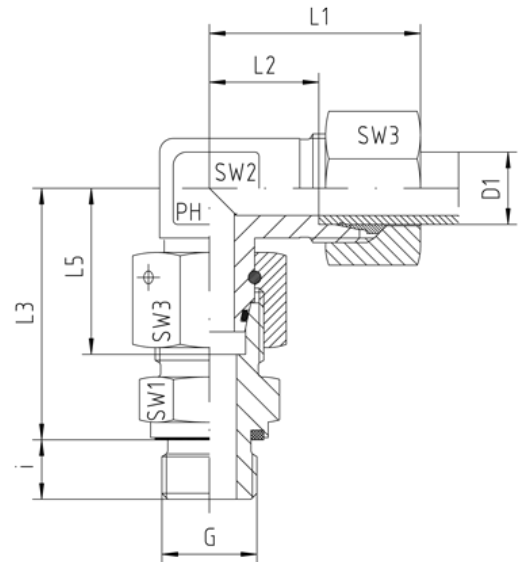
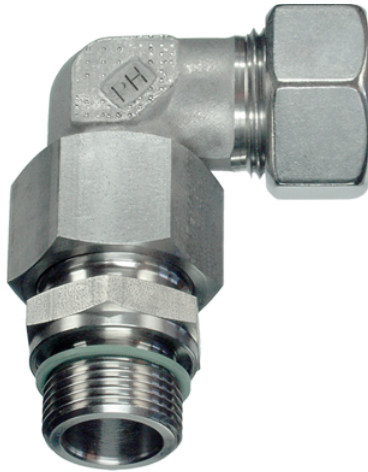

Einstellbare Winkel-Verschraubungen mit Dichtkegel und O-Ring FKM Rohrseitig Schneidringanschluss Einschraubgewinde: Metrisches Feingewinde - Zylindrisch wd = Abdichtung durch Profildichtung - FKM

| Druck | Rohr A.D. | Gewinde | Ca. Maße | | | | | | | | Bestellzeichen |
|-------|-----------|---------|----------|----|----|----|---|-----|-----|-----|----------------|
| | | | L1 | L2 | L3 | L5 | i | SW1 | SW2 | SW3 | |

Reihe L

| | | | | | | | | | | | |
|-----|----|------------|----|------|------|------|----|----|----|----|------------------------|
| 500 | 6 | M 10 x 1 | 27 | 12,0 | 34,5 | 26,0 | 8 | 14 | 12 | 14 | EW-DKOL-06-M 10x1-wd |
| 500 | 8 | M 12 x 1,5 | 29 | 14,0 | 37,5 | 27,5 | 12 | 17 | 12 | 17 | EW-DKOL-08-M 12x1,5-wd |
| 500 | 10 | M 14 x 1,5 | 30 | 15,0 | 40,0 | 29,0 | 12 | 19 | 14 | 19 | EW-DKOL-10-M 14x1,5-wd |
| 400 | 12 | M 16 x 1,5 | 32 | 17,0 | 42,0 | 29,5 | 12 | 22 | 17 | 22 | EW-DKOL-12-M 16x1,5-wd |
| 400 | 15 | M 18 x 1,5 | 36 | 21,0 | 46,0 | 32,5 | 12 | 24 | 19 | 27 | EW-DKOL-15-M 18x1,5-wd |
| 400 | 18 | M 22 x 1,5 | 40 | 23,5 | 50,0 | 35,5 | 14 | 27 | 24 | 32 | EW-DKOL-18-M 22x1,5-wd |
| 250 | 22 | M 26 x 1,5 | 44 | 27,5 | 55,0 | 38,5 | 16 | 32 | 27 | 36 | EW-DKOL-22-M 26x1,5-wd |
| 250 | 28 | M 33 x 2 | 47 | 30,5 | 59,0 | 41,5 | 18 | 41 | 36 | 41 | EW-DKOL-28-M 33x2-wd |
| 250 | 35 | M 42 x 2 | 56 | 34,5 | 68,5 | 51,0 | 20 | 50 | 41 | 50 | EW-DKOL-35-M 42x2-wd |
| 250 | 42 | M 48 x 2 | 63 | 40,0 | 75,0 | 56,0 | 22 | 55 | 50 | 60 | EW-DKOL-42-M 48x2-wd |

Reihe S

| | | | | | | | | | | | |
|-----|----|------------|----|------|------|------|----|----|----|----|------------------------|
| 800 | 6 | M 12 x 1,5 | 31 | 16,0 | 40,0 | 27,0 | 12 | 17 | 12 | 17 | EW-DKOS-06-M 12x1,5-wd |
| 800 | 8 | M 14 x 1,5 | 32 | 17,0 | 42,5 | 27,5 | 12 | 19 | 14 | 19 | EW-DKOS-08-M 14x1,5-wd |
| 800 | 10 | M 16 x 1,5 | 34 | 17,5 | 45,0 | 30,0 | 12 | 22 | 17 | 22 | EW-DKOS-10-M 16x1,5-wd |
| 630 | 12 | M 18 x 1,5 | 38 | 21,5 | 48,0 | 31,0 | 12 | 24 | 17 | 24 | EW-DKOS-12-M 18x1,5-wd |
| 630 | 14 | M 20 x 1,5 | 40 | 22,0 | 54,0 | 35,0 | 14 | 27 | 19 | 27 | EW-DKOS-14-M 20x1,5-wd |
| 630 | 16 | M 22 x 1,5 | 43 | 24,5 | 55,0 | 36,5 | 14 | 27 | 24 | 30 | EW-DKOS-16-M 22x1,5-wd |

| | | | | | | | | | | | |
|-----|----|----------|----|------|------|------|----|----|----|----|----------------------|
| 420 | 20 | M 27 x 2 | 48 | 26,5 | 65,0 | 44,5 | 16 | 32 | 27 | 36 | EW-DKOS-20-M 27x2-wd |
| 420 | 25 | M 33 x 2 | 54 | 30,0 | 73,0 | 50,0 | 18 | 41 | 36 | 46 | EW-DKOS-25-M 33x2-wd |
| 420 | 30 | M 42 x 2 | 62 | 35,5 | 78,5 | 55,0 | 20 | 50 | 41 | 50 | EW-DKOS-30-M 42x2-wd |
| 420 | 38 | M 48 x 2 | 72 | 41,0 | 89,0 | 63,0 | 22 | 55 | 50 | 60 | EW-DKOS-38-M 48x2-wd |