

## Rubrik 10.12

### WAS - Winkel-Verschraubungsstutzen - OMD

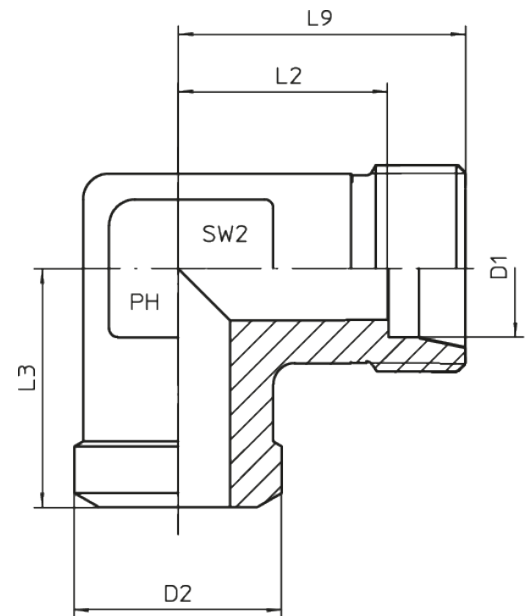

#### Winkel-Anschweißverschraubungsstutzen

Druck	Rohr A.D.		Ca. Maße				Bestellzeichen
	PN	D1	D2	L2	L3	L9	

#### Reihe L

500	6	10	12,0	19,0	19,0	12,0	WAS-L-06-OMD
500	8	12	14,0	23,0	21,0	12,0	WAS-L-08-OMD
500	10	14	15,0	24,0	22,0	14,0	WAS-L-10-OMD
400	12	16	17,0	25,0	24,0	17,0	WAS-L-12-OMD
400	15	19	21,0	30,0	28,0	19,0	WAS-L-15-OMD
400	18	22	23,5	33,0	31,0	24,0	WAS-L-18-OMD
250	22	27	27,5	37,0	35,0	27,0	WAS-L-22-OMD
250	28	32	30,5	42,0	38,0	36,0	WAS-L-28-OMD
250	35	40	34,5	49,0	45,0	41,0	WAS-L-35-OMD
250	42	46	40,0	57,0	51,0	50,0	WAS-L-42-OMD

#### Reihe S

800	6	11	16,0	23,0		12,0	WAS-S-06-OMD
800	8	13	17,0	24,0	24,0	14,0	WAS-S-08-OMD
800	10	15	17,5	25,0	25,0	17,0	WAS-S-10-OMD
630	12	17	21,5	29,0	29,0	17,0	WAS-S-12-OMD
630	14	19	22,0	30,0		19,0	WAS-S-14-OMD

630	16	21	24,5	33,0	33,0	24,0	WAS-S-16-OMD
420	20	26	26,5	37,0	37,0	27,0	WAS-S-20-OMD
420	25	31	30,0	42,0	42,0	36,0	WAS-S-25-OMD
420	30	36	35,5	49,0	49,0	41,0	WAS-S-30-OMD
420	38	44	41,0	57,0	57,0	50,0	WAS-S-38-OMD