

Rubrik 10.19

Schweißnippel-Rohrbögen - 90°

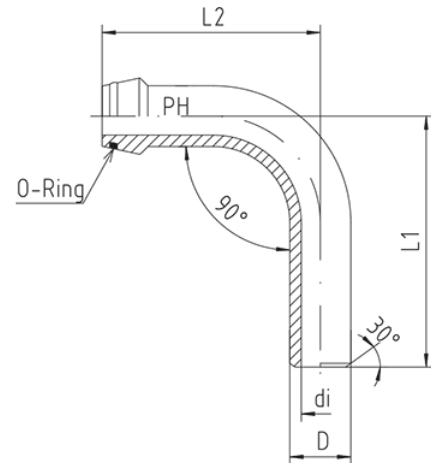

Mit O-Ring Abdichtung - NBR
 Auf Anfrage: FPM
 Passend in 24°-Innenkonus
 Bohrungsform W DIN 3861

Druck	Rohr	Ca. Maße				O-Ring	Bestellzeichen
		L1	L2	D	di		
PN							
Reihe S							
460	10 x 2	49,0	51,0	10	6	8,0 x 1,5	SKV-RB-10x2
393	12 x 2	50,0	51,0	12	8	10,0 x 1,5	SKV-RB-12x2
476	12 x 2,5	50,0	51,0	12	7	10,0 x 1,5	SKV-RB-12x2,5
305	16 x 2	72,0	67,0	16	12	13,0 x 2,0	SKV-RB-16x2
372	16 x 2,5	72,0	67,0	16	11	13,0 x 2,0	SKV-RB-16x2,5
435	16 x 3	72,0	67,0	16	10	13,0 x 2,0	SKV-RB-16x3
249	20 x 2	89,0	86,0	20	16	16,3 x 2,4	SKV-RB-20x2
305	20 x 2,5	89,0	86,0	20	15	16,3 x 2,4	SKV-RB-20x2,5
358	20 x 3	89,0	86,0	20	14	16,3 x 2,4	SKV-RB-20x3
294	25 x 3	93,0	89,0	25	19	21,3 x 2,4	SKV-RB-25x3
379	25 x 4	93,0	89,0	25	17	21,3 x 2,4	SKV-RB-25x4
460	25 x 5	93,0	89,0	25	15	21,3 x 2,4	SKV-RB-25x5
323	30 x 4	112,0	105,0	30	22	25,3 x 2,4	SKV-RB-30x4
393	30 x 5	112,0	105,0	30	20	25,3 x 2,4	SKV-RB-30x5
460	30 x 6	112,0	105,0	30	18	25,3 x 2,4	SKV-RB-30x6
261	38 x 4	145,0	137,0	38	30	34,0 x 2,5	SKV-RB-38x4

319	38 x 5	145,0	137,0	38	28	34,0 x 2,5	SKV-RB-38x5
375	38 x 6	145,0	137,0	38	26	34,0 x 2,5	SKV-RB-38x6
429	38 x 7	145,0	137,0	38	24	34,0 x 2,5	SKV-RB-38x7

Reihe L

328	22 x 3	79,0	85,0	22	16	19,0 x 2,0	SKV-RB-22x3
-----	--------	------	------	----	----	------------	-------------