

## Rubrik 9.53

### DA - DKO - SC

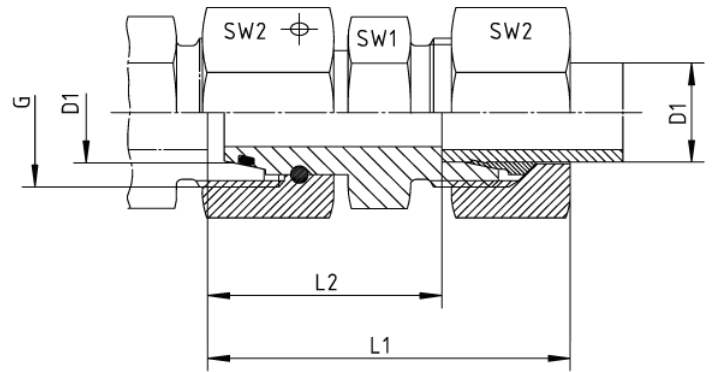
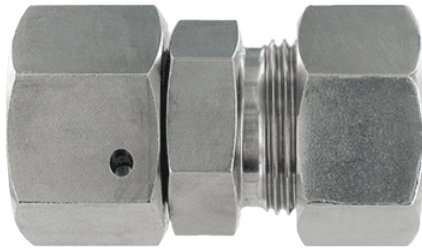

Mit Dichtkegel und O-Ring (DKO) - FKM Passend in Bohrungsform W DIN 3861

Druck	Rohr A.D.	Gewinde	Ca. Maße				Bestellzeichen
PN	D1	G	L1	L2	SW1	SW2	

#### Reihe L

500	6	M 12 x 1,5	51,0	36,0	12	14	DA-DKOL-06-SC
500	8	M 14 x 1,5	51,0	36,0	14	17	DA-DKOL-08-SC
500	10	M 16 x 1,5	51,0	36,0	17	19	DA-DKOL-10-SC
400	12	M 18 x 1,5	51,0	36,0	19	22	DA-DKOL-12-SC
400	15	M 22 x 1,5	51,0	36,0	24	27	DA-DKOL-15-SC
400	18	M 26 x 1,5	52,0	36,0	27	32	DA-DKOL-18-SC
250	22	M 30 x 2	56,0	40,0	32	36	DA-DKOL-22-SC
250	28	M 36 x 2	57,0	40,0	41	41	DA-DKOL-28-SC
250	35	M 45 x 2	72,0	50,0	46	50	DA-DKOL-35-SC
250	42	M 52 x 2	83,0	60,0	55	60	DA-DKOL-42-SC

#### Reihe S

800	6	M 14 x 1,5	51,0	36,0	14	17	DA-DKOS-06-SC
800	8	M 16 x 1,5	51,0	36,0	17	19	DA-DKOS-08-SC
800	10	M 18 x 1,5	52,0	36,0	19	22	DA-DKOS-10-SC
630	12	M 20 x 1,5	52,0	36,0	22	24	DA-DKOS-12-SC
630	14	M 22 x 1,5	58,0	40,0	24	27	DA-DKOS-14-SC
630	16	M 24 x 1,5	58,0	40,0	27	30	DA-DKOS-16-SC

420	20	M 30 x 2	68,0	46,0	32	36	DA-DKOS-20-SC
420	25	M 36 x 2	74,0	50,0	41	46	DA-DKOS-25-SC
420	30	M 42 x 2	83,0	56,0	46	50	DA-DKOS-30-SC
420	38	M 52 x 2	91,0	60,0	55	60	DA-DKOS-38-SC