



EDELSTAHL / STAINLESS STEEL  
VERBINDUNGSTECHNIK  
FLUID CONNECTORS

## Messanschlüsse Pressure Gauge Connectors



# 14





## MESSANSCHLÜSSE PRESSURE GAUGE CONNECTORS

Produktgruppen	Product-Groups	Seite / Page	
<b>MAS - Messanschlüsse</b>	<b>MAS - Test Point - Pressure - Gauge - Connectors</b>		
MAS - Metrisch mit O-Ring	MAS - Metric with O-Ring	14.2	
MAS - Withworth Rohrgewinde	MAS - BSP Parallel	14.2	
MAS - NPT	MAS - NPT	14.2	
<b>GMV - Gerade - Messverschraubungen</b>	<b>GMV - Straight - Test Point - Pressure - Gauge - Fittings</b>		
GMV - Standard	GMV - Standard	14.3	
GMV - SC	GMV - SC	14.4	
GMV - OMD	GMV - OMD	14.5	
<b>VKA-DKO - Messanschlüsse</b>	<b>VKA-DKO - Test Point - Pressure - Gauge - Connectors</b>		
VKA - DKOL	VKA - DKOL	14.6	
VKA - DKOS	VKA - DKOS	14.6	
<b>SMS - Hochdruck - Messschläuche</b>	<b>SMS - High Pressure - Test - Hoses</b>		
SMS - Hochdruck Messschläuche	SMS - High Pressure Test Hoses	14.7	
<b>SMA - Manometer - Messanschlüsse</b>	<b>SMA - Gauge Test Adaptors</b>		
SMA - Manometer - Messanschlüsse	SMA - Gauge Test Adaptors	14.8	
<b>SMD - Manometer-Direktanschlüsse</b>	<b>SMD - Direct - Gauge - Adaptors</b>		
SMD - Manometer - Direktanschlüsse	SMD - Direct - Gauge - Adaptors	14.9	

**Standard** = Überwurfmutter blank / Tube nuts are supplied unplated  
**SC** = Überwurfmutter bis Größe 12-S ist gleitbeschichtet / Tube nuts until size 12-L are supplied chemical plated  
= Überwurfmutter ab Größe 12-S ist mit versilbertem Gewinde / Tube nuts from size 12-S are supplied with silver plated thread  
**OMD** = Verschraubung ohne Überwurfmutter und Schneidring am Außengewinde / Couplings are supplied without nut and cutting ring at male thread

Mit Schraubkupplung M 16 x 2  
 O-Ring - FPM

With Connection M 16 x 2  
 O-ring - FPM

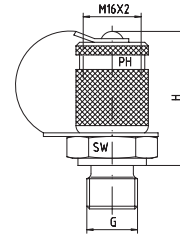

Druck Pressure	Gewinde Thread	Ca. Maße Approx. Dimensions		Abdichtung Sealing	Bemerkungen Notes	Bestellzeichen Order-Code	Brutto-Preis Gross-Price
PN	G	H	SW				Euro (€)
630	M 8 x 1	37,0	17	O-Ring Form A		MAS-M 8x1-or	48,06
630	M 10 x 1	37,0	17	O-Ring Form A		MAS-M 10x1-or	48,06
630	M 10 x 1	37,0	17	Weichdichtung / Soft Sealing Form C		MAS-M 10x1-wd	50,10
630	M 12 x 1,5	37,0	17	Weichdichtung / Soft Sealing Form C		MAS-M 12x1,5-wd	53,50
630	M 14 x 1,5	37,0	19	Weichdichtung / Soft Sealing Form C		MAS-M 14x1,5-wd	48,06
630	M 16 x 1,5	37,0	22	Weichdichtung / Soft Sealing Form C		MAS-M 16x1,5-wd	48,06
630	G 1/8"	37,0	17	Weichdichtung / Soft Sealing Form C		MAS-G 1/8"-wd	48,06
630	G 1/4"	37,0	19	Weichdichtung / Soft Sealing Form C		MAS-G 1/4"-wd	48,06
630	G 3/8"	40,0	22	Weichdichtung / Soft Sealing Form C		MAS-G 3/8"-wd	52,85
630	G 1/2"	40,0	27	Weichdichtung / Soft Sealing Form C		MAS-G 1/2"-wd	75,50
630	R 1/8" keg	36,0	17	Gewinde / Thread Form D		MAS-R 1/8"-k	57,60
630	R 1/4" keg	36,0	17	Gewinde / Thread Form D		MAS-R 1/4"-k	57,60
630	1/8" NPT	36,0	17	Gewinde / Thread Form D		MAS-1/8"-NPT	57,60
630	1/4" NPT	37,0	17	Gewinde / Thread Form D		MAS-1/4"-NPT	57,60
630	3/8" NPT	40,0	19	Gewinde / Thread Form D		MAS-3/8"-NPT	68,50
630	1/2" NPT	40,0	22	Gewinde / Thread Form D		MAS-1/2"-NPT	75,90

Form A

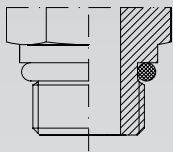

Abdichtung durch Runddichtung (O-Ring) - SAE J 514  
 Sealing by O-ring in Thread Undercut - SAE J 514

Form C

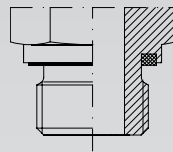

WD = Abdichtung durch gekammerte Profildichtung - FPM  
 WD = Sealing by an Elastomer Captive Profiled Ring - FPM

Form D

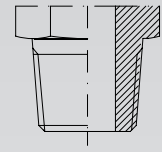

Abdichtung kegelig oder NPT  
 Sealing by Taper or NPT



Mit Schraubkupplung M 16 x 2  
O-Ring - FPM  
Lieferung komplett mit Mutter und Schneidring

With Connection M 16 x 2  
O-ring - FPM  
Delivery complete with Nut and Cutting Ring

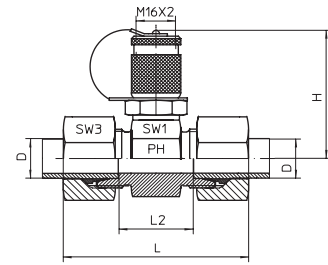

Reihe / Series L

Druck Pressure	Rohr A.D. Tube O.D.	Ca. Maße Approx. Dimensions					Bemerkungen Notes	Bestellzeichen Order-Code	Brutto-Preis Gross-Price
PN	D	L	L2	H	SW1	SW3			Euro (€)
315	6	50,5	27,0	49,5	24	14		GMV-L-06	124,75
315	8	50,5	27,0	49,5	24	17		GMV-L-08	125,25
315	10	52,5	29,0	49,5	24	19		GMV-L-10	126,25
315	12	52,5	29,0	49,5	24	22		GMV-L-12	127,75
315	15	54,5	29,0	52,5	30	27		GMV-L-15	129,25
315	18	56,5	29,0	53,5	32	32		GMV-L-18	131,25
160	22	60,5	33,0	55,5	36	36		GMV-L-22	138,75
160	28	60,5	33,0	58,0	41	41		GMV-L-28	181,50
160	35	68,5	31,0	60,5	46	50		GMV-L-35	281,20
160	42	70,5	36,0	65,0	55	60		GMV-L-42	357,50

Reihe / Series S

Druck Pressure	Rohr A.D. Tube O.D.	Ca. Maße Approx. Dimensions					Bemerkungen Notes	Bestellzeichen Order-Code	Brutto-Preis Gross-Price
PN	D	L	L2	H	SW1	SW3			Euro (€)
630	6	54,5	31,0	49,5	24	17		GMV-S-06	125,25
630	8	54,5	31,0	49,5	24	19		GMV-S-08	126,25
630	10	56,5	30,0	49,5	24	22		GMV-S-10	127,75
630	12	56,5	28,0	49,5	24	24		GMV-S-12	128,90
630	14	62,5	31,0	51,0	27	27		GMV-S-14	129,25
400	16	62,5	30,0	52,5	30	30		GMV-S-16	131,25
400	20	68,5	31,0	55,5	36	36		GMV-S-20	138,75
400	25	74,5	32,0	58,0	41	46		GMV-S-25	181,50
400	30	80,5	33,0	60,5	46	50		GMV-S-30	281,20
315	38	91,0	32,0	65,0	55	60		GMV-S-38	357,50

# GMV - GERADE - MESSVERSCHRAUBUNGEN

GMV - STRAIGHT - TEST POINT - PRESSURE - GAUGE - FITTINGS



EDELSTAHL / STAINLESS STEEL  
VERBINDUNGSTECHNIK  
FLUID CONNECTORS

Mit Schraubkupplung M 16 x 2  
O-Ring - FPM  
Lieferung komplett mit Mutter und Schneidring

With Connection M 16 x 2  
O-ring - FPM  
Delivery complete with Nut and Cutting Ring

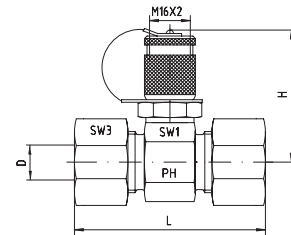

## Reihe / Series L

Druck Pressure	Rohr A.D. Tube O.D.	Ca. Maße Approx. Dimensions		Bemerkungen Notes		Bestellzeichen Order-Code	Brutto-Preis Gross-Price
PN	D	L	H	SW1	SW3		Euro (€)
315	6	50,5	49,5	24	14	GMV-L-06-SC	125,39
315	8	50,5	49,5	24	17	GMV-L-08-SC	126,13
315	10	52,5	49,5	24	19	GMV-L-10-SC	127,13
315	12	52,5	49,5	24	22	GMV-L-12-SC	128,87
315	15	54,5	52,5	30	27	GMV-L-15-SC	131,41
315	18	56,5	53,5	32	32	GMV-L-18-SC	134,53
160	22	60,5	55,5	36	36	GMV-L-22-SC	142,03
160	28	60,5	58,0	41	41	GMV-L-28-SC	185,50
160	35	68,5	60,5	46	50	GMV-L-35-SC	288,64
160	42	70,5	65,0	55	60	GMV-L-42-SC	366,14

## Reihe / Series S

Druck Pressure	Rohr A.D. Tube O.D.	Ca. Maße Approx. Dimensions		Bemerkungen Notes		Bestellzeichen Order-Code	Brutto-Preis Gross-Price
PN	D	L	H	SW1	SW3		Euro (€)
630	6	54,5	49,5	24	17	GMV-S-06-SC	126,13
630	8	54,5	49,5	24	19	GMV-S-08-SC	127,13
630	10	56,5	49,5	24	22	GMV-S-10-SC	128,87
630	12	56,5	49,5	24	24	GMV-S-12-SC	130,58
630	14	62,5	51,0	27	27	GMV-S-14-SC	132,37
400	16	62,5	52,5	30	30	GMV-S-16-SC	134,37
400	20	68,5	55,5	36	36	GMV-S-20-SC	134,99
400	25	74,5	58,0	41	46	GMV-S-25-SC	187,50
400	30	80,5	60,5	46	50	GMV-S-30-SC	289,52
315	38	91,0	65,0	55	60	GMV-S-38-SC	368,78



Mit Schraubkupplung M 16 x 2  
O-Ring - FPM

With Connection M 16 x 2  
O-ring - FPM

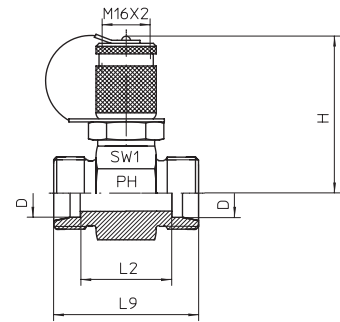

Reihe / Series L

Druck Pressure	Rohr A.D. Tube O.D.					Bemerkungen Notes	Bestellzeichen Order-Code	Brutto-Preis Gross-Price
PN	D	L2	L9	H	SW1			Euro (€)
315	6	27,0	41,0	49,5	24,0		GMV-L-06-OMD	120,13
315	8	27,0	41,0	49,5	24,0		GMV-L-08-OMD	119,65
315	10	29,0	43,0	49,5	24,0		GMV-L-10-OMD	119,53
315	12	29,0	43,0	49,5	24,0		GMV-L-12-OMD	119,97
315	15	29,0	43,0	52,5	30,0		GMV-L-15-OMD	118,97
315	18	29,0	44,0	53,5	32,0		GMV-L-18-OMD	114,01
160	22	33,0	48,0	55,5	36,0		GMV-L-22-OMD	118,13
160	28	33,0	48,0	58,0	41,0		GMV-L-28-OMD	151,80
160	35	31,0	52,0	60,5	46,0		GMV-L-35-OMD	238,98
160	42	36,0	58,0	65,0	55,0		GMV-L-42-OMD	302,64

Reihe / Series S

Druck Pressure	Rohr A.D. Tube O.D.					Bemerkungen Notes	Bestellzeichen Order-Code	Brutto-Preis Gross-Price
PN	D	L2	L9	H	SW1			Euro (€)
630	6	31,0	45,0	49,5	24,0		GMV-S-06-OMD	119,67
630	8	31,0	45,0	49,5	24,0		GMV-S-08-OMD	119,85
630	10	30,0	45,0	49,5	24,0		GMV-S-10-OMD	119,87
630	12	28,0	43,0	49,5	24,0		GMV-S-12-OMD	120,00
630	14	31,0	47,0	51,0	27,0		GMV-S-14-OMD	118,25
400	16	30,0	47,0	52,5	30,0		GMV-S-16-OMD	114,83
400	20	31,0	52,0	55,5	36,0		GMV-S-20-OMD	117,59
400	25	32,0	56,0	58,0	41,0		GMV-S-25-OMD	144,26
400	30	33,0	60,0	60,5	46,0		GMV-S-30-OMD	234,32
315	38	32,0	64,0	65,0	55,0		GMV-S-38-OMD	294,22

Mit Schraubkupplung M 16 x 2  
Anschluss mit Dichtkegel und O-Ring - FPM  
Passend in Bohrungsform W DIN 3861  
Mit 24°-Konus

With Connection M 16 x 2  
Connection with Taper and O-ring - FPM  
For Port End W DIN 3861  
With 24°-cone

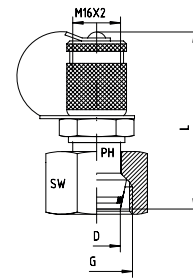

Reihe / Series L

Druck Pressure	Rohr A.D. Tube O.D.	Gewinde Thread	Ca. Maße Approx. Dimensions		Bemerkungen Notes	Bestellzeichen Order-Code	Brutto-Preis Gross-Price
PN	D	G	L	SW			Euro (€)
315	6	M 12 x 1,5	72,0	14		VKA-DKOL-06	102,25
315	8	M 14 x 1,5	58,0	17		VKA-DKOL-08	102,25
315	10	M 16 x 1,5	58,0	19		VKA-DKOL-10	102,25
315	12	M 18 x 1,5	54,0	22		VKA-DKOL-12	79,25
315	15	M 22 x 1,5	57,0	27		VKA-DKOL-15	82,83
315	18	M 26 x 1,5	59,0	32		VKA-DKOL-18	90,50
160	22	M 30 x 2	60,0	36		VKA-DKOL-22	99,70
160	28	M 36 x 2	65,0	41		VKA-DKOL-28	107,40
160	35	M 45 x 2	70,0	50		VKA-DKOL-35	127,82
160	42	M 52 x 2	71,0	60		VKA-DKOL-42	166,15

Reihe / Series S

Druck Pressure	Rohr A.D. Tube O.D.	Gewinde Thread	Ca. Maße Approx. Dimensions		Bemerkungen Notes	Bestellzeichen Order-Code	Brutto-Preis Gross-Price
PN	D	G	L	SW			Euro (€)
630	6	M 14 x 1,5	72,0	17		VKA-DKOS-06	102,25
630	8	M 16 x 1,5	58,0	19		VKA-DKOS-08	102,25
630	10	M 18 x 1,5	58,0	22		VKA-DKOS-10	102,25
630	12	M 20 x 1,5	54,0	24		VKA-DKOS-12	79,50
630	14	M 22 x 1,5	70,0	27		VKA-DKOS-14	82,83
400	16	M 24 x 1,5	55,0	30		VKA-DKOS-16	90,50
400	20	M 30 x 2	64,0	36		VKA-DKOS-20	99,70
400	25	M 36 x 2	66,0	46		VKA-DKOS-25	107,40
400	30	M 42 x 2	70,0	50		VKA-DKOS-30	128,90
315	38	M 52 x 2	72,0	60		VKA-DKOS-38	168,15





Mit Schraubkupplung M 16 x 2

With Metric Swivel End M 16 x 2

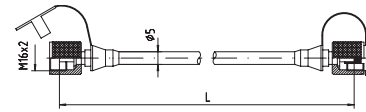

Druck Pressure	Schlauch Hose	Gewinde Thread	Länge Length	Bemerkungen Notes	Bestellzeichen Order-Code	Brutto-Preis Gross-Price
PN	DN		L			Euro (€)
630	02	M 16 x 2	200		SMS-M 16-200	96,60
630	02	M 16 x 2	400		SMS-M 16-400	96,90
630	02	M 16 x 2	630		SMS-M 16-630	97,15
630	02	M 16 x 2	800		SMS-M 16-800	97,40
630	02	M 16 x 2	1000		SMS-M 16-1000	97,65
630	02	M 16 x 2	1500		SMS-M 16-1500	99,15
630	02	M 16 x 2	2000		SMS-M 16-2000	99,65
630	02	M 16 x 2	2500		SMS-M 16-2500	100,15
630	02	M 16 x 2	3200		SMS-M 16-3200	102,15
630	02	M 16 x 2	4000		SMS-M 16-4000	103,95

# SMA - MANOMETER - MESSANSCHLÜSSE

SMA - GAUGE - TEST - ADAPTORS



EDELSTAHL / STAINLESS STEEL  
VERBINDUNGSTECHNIK  
FLUID CONNECTORS

Innengewinde - Starr: BSP + NPT  
Außengewinde: M 16 x 2  
Dichtung: FPM

Female Thread: BSP + NPT  
Male Thread: M 16 x 2  
Sealing: FPM

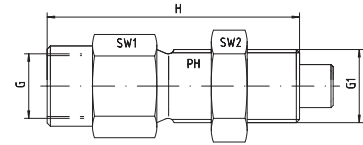
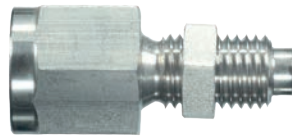

Druck Pressure	Gewinde Thread		Ca. Maße Approx. Dimensions			Bemerkungen Notes	Bestellzeichen Order-Code	Brutto-Preis Gross-Price
	PN	G	G1	H	SW1			SW2
630	1/4" BSP	M 16 x 2	50,0	19	19		SMA-20-G 1/4"-V	97,00
630	1/2" BSP	M 16 x 2	60,0	27	19		SMA-20-G 1/2"-V	126,77
630	1/4" NPT	M 16 x 2	50,0	19	19		SMA-20-1/4"-NPT-V	139,00
630	1/2" NPT	M 16 x 2	60,0	27	19		SMA-20-1/2"-NPT-V	196,00



Innengewinde - Starr: BSP + NPT  
 Muttergewinde: M 16 x 2

Female Thread: BSP + NPT  
 Nut Female Swivel: M 16 x 2

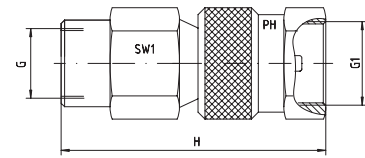
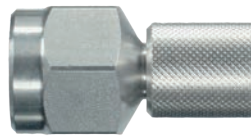

Druck Pressure	Gewinde Thread		Ca. Maße Approx. Dimensions		Bemerkungen Notes	Bestellzeichen Order-Code	Brutto-Preis Gross-Price
PN	G	G1	H	SW1			Euro (€)
630	1/4" BSP	M 16 x 2	41,0	19		SMD-20-R 1/4"	96,43
630	1/2" BSP	M 16 x 2	51,0	27		SMD-20-R 1/2"	156,00
630	1/4" NPT	M 16 x 2	41,0	19		SMD-20-1/4"-NPT	119,00
630	1/2" NPT	M 16 x 2	51,0	27		SMD-20-1/2"-NPT	*

\*Preis auf Anfrage/\*Price on request

